

DIN rails are standardized mounting components used for various devices. They come in different versions, lengths, and materials, such as steel, copper, aluminium, or stainless steel. DIN rails are standardized and certified according to EN 60715 and are made of steel class. 11, surfaced in design Sendzimir according to EN 10346-2009-03.

TS 35 x 7,5 solid

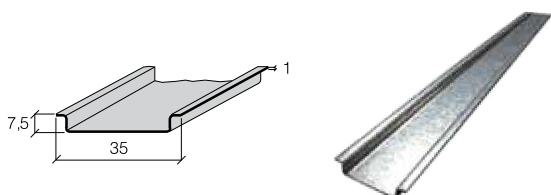

Order code	Length (mm)	Weight (g)	Package (m)
MMD7520A29	2000	680	40 / 2160
MMD7510A29	1000	340	20 / 1080

TS 35 x 7,5 perforated (5,2 x 25 mm)

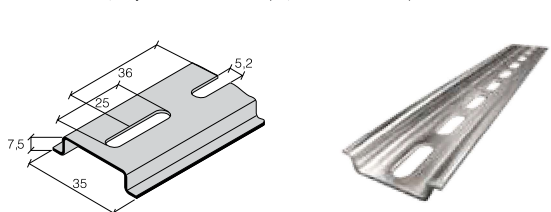

Order code	Length (mm)	Weight (g)	Package (m)
MMD7520B29	2000	600	40 / 2160
MMD7510B29	1000	300	20 / 1080

TS 35 x 7,5 perforated (6,3 x 18 mm)

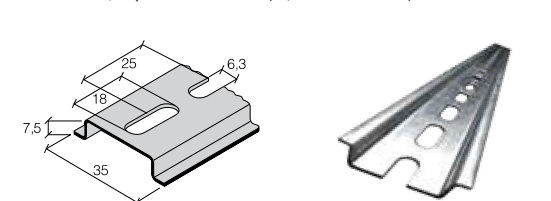

Order code	Length (mm)	Weight (g)	Package (m)
MMD7520C29	2000	600	40 / 2160
MMD7510C29	1000	300	20 / 1080

TS 35 x 15 solid

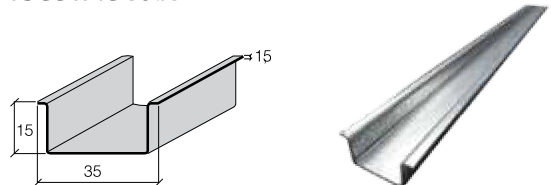

Order code	Length (mm)	Weight (g)	Package (m)
MMD1520A29	2000	1320	20 / 1080

TS 35 x 15 perforated (5,2 x 25 mm)

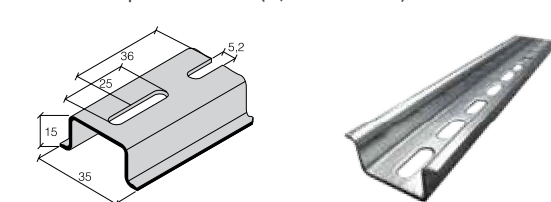

Order code	Length (mm)	Weight (g)	Package (m)
MMD1520B29	2000	1200	20 / 1080

TS 35 x 15 perforated (6,3 x 18 mm)

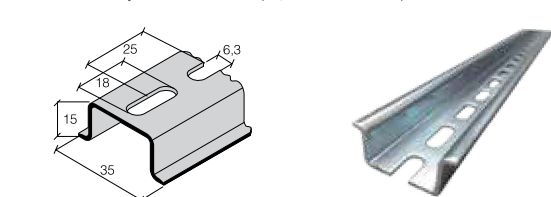

Order code	Length (mm)	Weight (g)	Package (m)
MMD1520C29	2000	1200	20 / 1080

**DIN rails are standardized mounting components used for various devices. They come in different versions, lengths, and materials, such as steel, copper, aluminium, or stainless steel. DIN rails are made of steel class. 11, surfaced in design galvanic zinc plating and passivation. We can deliver also customized rails made of copper, aluminium or stainless steel.**

TS 35 x 7,5 Galvanic Zn solid

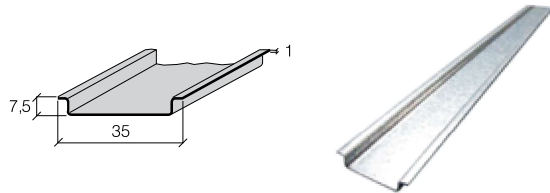

Order code	Length (mm)	Weight (g)	Package (m)
MMD7520Z00	2000	680	40 / 2160

TS 35 x 7,5 Galvanic Zn perforated (5,2 x 25 mm)

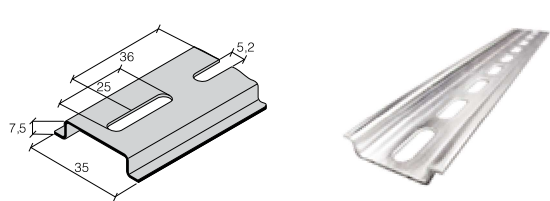

Order code	Length (mm)	Weight (g)	Package (m)
MMD7520Z52	2000	600	40 / 2160

TS 35 x 7,5 Galvanic Zn perforated (6,3 x 18 mm)

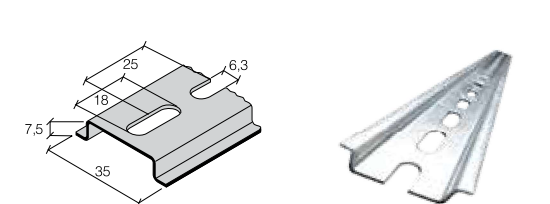

Order code	Length (mm)	Weight (g)	Package (m)
MMD7520Z63	2000	600	40 / 2160

TS 35 x 15 Galvanic Zn solid

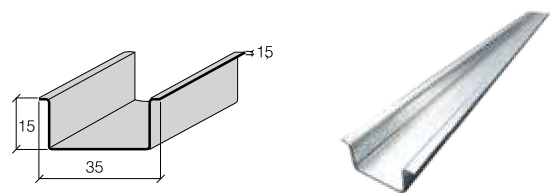

Order code	Length (mm)	Weight (g)	Package (m)
MMD1520Z00	2000	1320	20 / 1080

TS 35 x 15 Galvanic Zn perforated (5,2 x 25 mm)

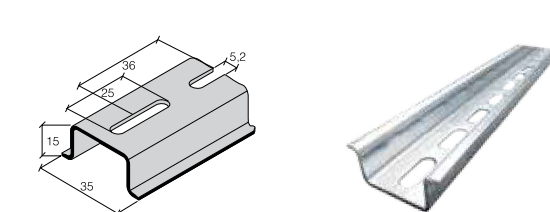

Order code	Length (mm)	Weight (g)	Package (m)
MMD1520Z52	2000	1200	20 / 1080

TS 35 x 15 Galvanic Zn perforated (6,3 x 18 mm)

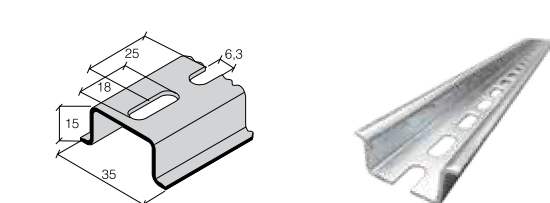

Order code	Length (mm)	Weight (g)	Package (m)
MMD1520Z63	2000	1200	20 / 1080

DIN rail brackets are used for mounting of DIN rails and defining the distance between the device and the installation cabinet wall. Sloping DIN bracket are used to fix the mounting rail in an angle of 30°.

It is possible to place DIN rails on the flat brackets horizontally to the wall. All brackets have an opening with metric thread M6 piece for easy and convenient connection to the DIN rail. DIN rail brackets are made of steel surfaced by zinc.

DIN rail bracket – flat



DIN rail bracket – sloping - pitch of the mounting holes 60 mm



Order code	Type	Thread	Package (pcs)
MMD6420A23	DIN rail bracket flat H20	M6	50
MMD6425A23	DIN rail bracket flat H25	M6	50
MMD6430A23	DIN rail bracket flat H30	M6	50
MMD6440A23	DIN rail bracket flat H40	M6	50
MMD6450A23	DIN rail bracket flat H50	M6	50
MMD6470A23	DIN rail bracket flat H70	M6	50
MMD6490A23	DIN rail bracket flat H90	M6	50

Order code	Type	Thread	Package (pcs)
MMD6049B23	DIN rail bracket sloping H49	M6	50

Dimensions

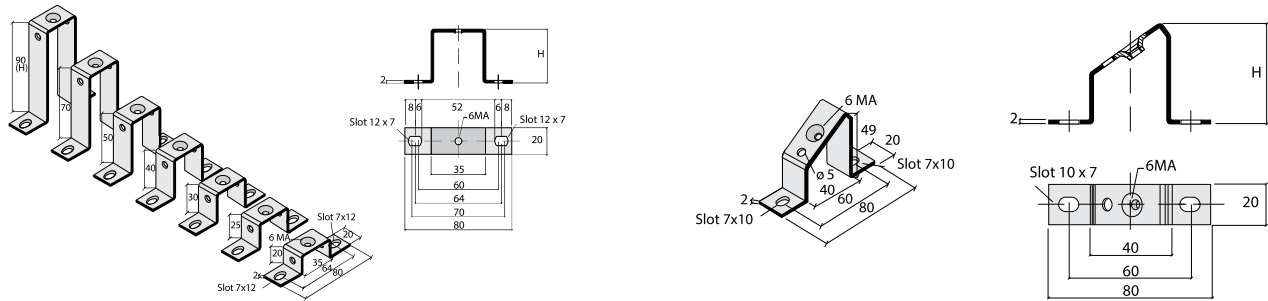

Mounting clips



Mounting clips for mounting rail, allow installation of components which are not pre-set to clip on to rail. Material: nickel-plated steel.

Order code	Type	Weight (g)	Package (pcs)
MMD5104A23	FIX-KLIPM4	4	100
MMD5105A23	FIX-KLIPM5	4	100

